

Images above and below shown without ribbon applique.

-  9900 383
-  9900 296
-  9900 78
-  9900 291
-  9900 34
-  9900 137
-  9900 48
-  9900 126
-  9900 127

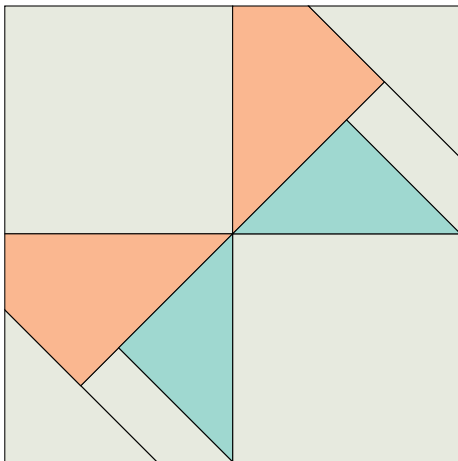

INGREDIENTS

12" BLOCK

FROM BACKGROUND FABRIC, CUT:

- * [A] (1) 7½" square
- * [B] (2) 6½" squares
- * [C] (2) 3½" squares

FROM FABRIC 1, CUT:
(CORAL)

- * [A] (1) 7½" square

FROM FABRIC 2, CUT:
(TEAL)

- * [A] (1) 7½" square

6" BLOCK

FROM BACKGROUND FABRIC, CUT:

- * [A] (1) 4½" square
- * [B] (2) 3½" squares
- * [C] (2) 2" squares

FROM FABRIC 1, CUT:
(CORAL)

- * [A] (1) 4½" square

FROM FABRIC 2, CUT:
(TEAL)

- * [A] (1) 4½" square

4" BLOCK

FROM BACKGROUND FABRIC, CUT:

- * [A] (1) 3½" square
- * [B] (2) 2½" squares
- * [C] (2) 1½" squares

FROM FABRIC 1 (CORAL), CUT:

- * [A] (1) 1½" square

FROM FABRIC 2 (TEAL), CUT:

- * [A] (1) 3½" square

You will also need a bit of ribbon to create the body of the butterfly.

YIELD 4", 6" or 12" block

BUTTERFLY

by Nicola Dodd

FEATURING:

Lady Bird
by Crystal Manning

Instructions are for the 12" block.

STEP 1. MAKE HSTS

Mark a diagonal line on the back of a 7½" background square and pin - right sides together - to the 7½" teal print square, then stitch ¼" away from each side of the marked line. Cut along that line and press both half square triangles (HSTs) open.

NOTE: You will only need one of these units, so set the remaining HST aside for another project.

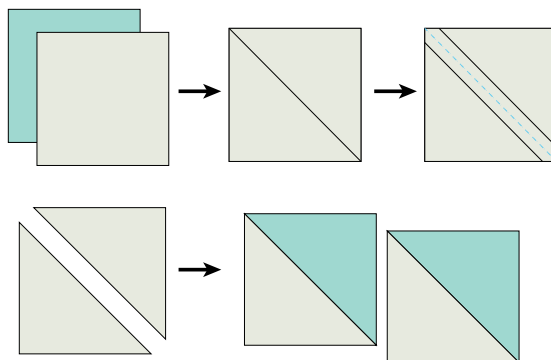

STEP 2. MAKE HSTS 2

Mark a diagonal line on the back of one of the HSTs at right-angles to the seam and pin - right sides together - to the coral 7½" square, as shown overleaf. Don't worry that the HSTs are slightly smaller, you will be trimming them down. Again, stitch ¼" away from each side of the marked line, cut apart and press open.

Please note that you will have two sets of mirror image wing units, A & B. Trim to 6½" square.

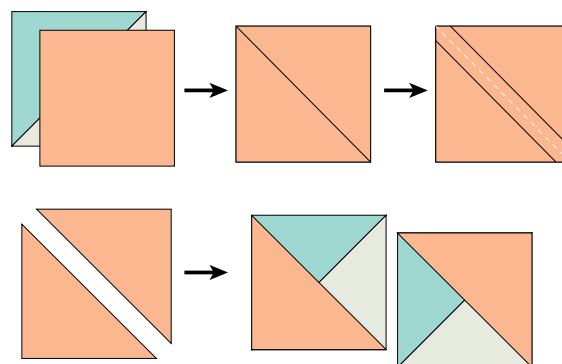

STEP 3. SNOWBALL CORNERS

Snowball the wing tips on both A & B wing units with 3½" background squares. First mark a diagonal line along the diagonal of the wrong side of C background square. Sew on the marked line. Repeat with remaining wing unit.

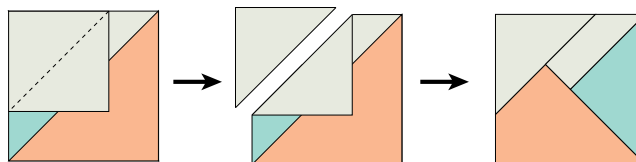

STEP 4. ASSEMBLE BLOCK

Assemble the butterfly by joining each wing to a 6½" background square, taking care with the placement. Then join the two rows together, pressing the seam open.

Turn a small seam on the ends of the ribbon - glue basting to secure - then applique to the block.

